

14x12x6 Fiberglass Weatherproof Vented NEMA Enclosure with 120 VAC Outlets, Cooling Fan and 200W Heater

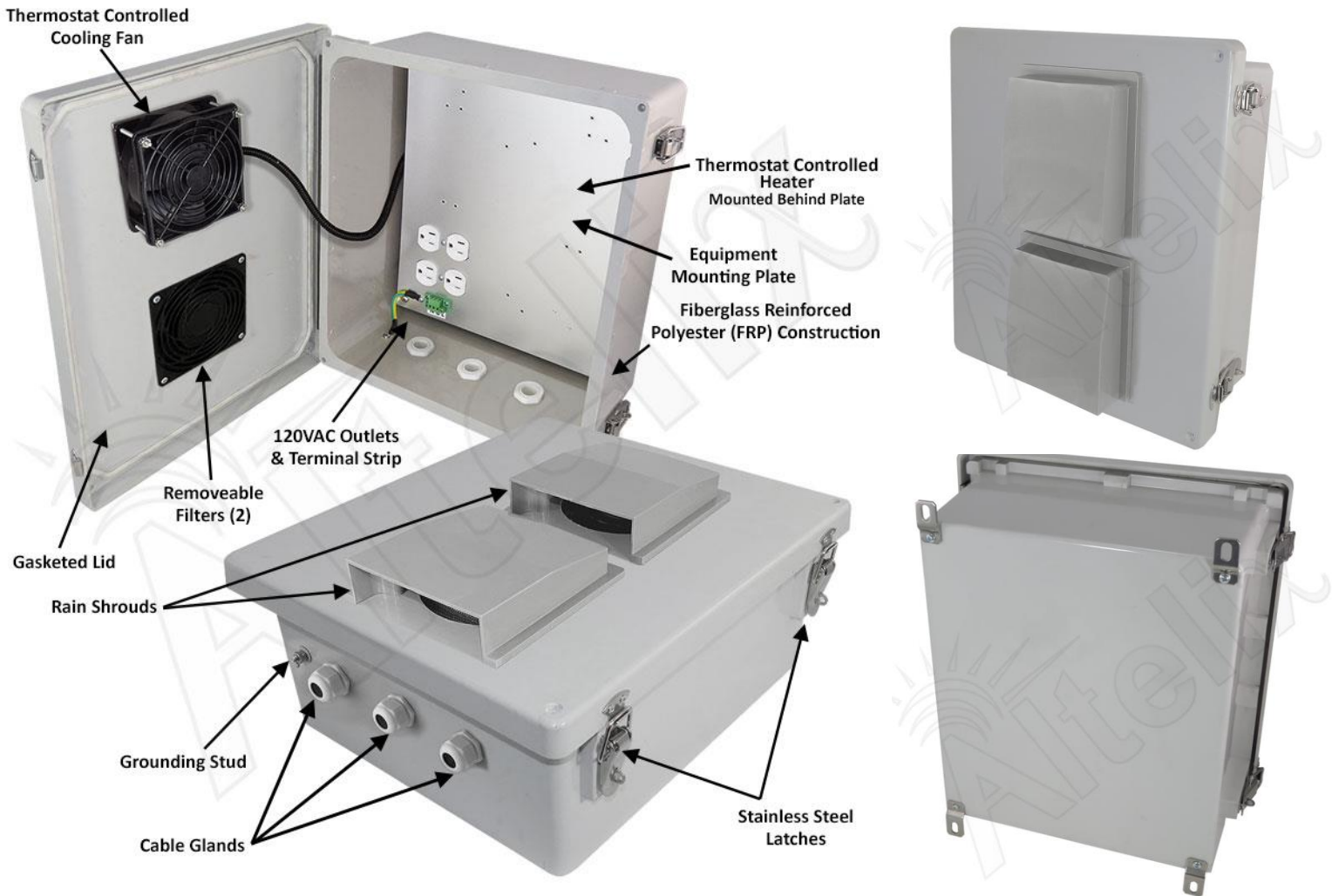

Features

- Thermostat Controlled Cooling Fan and 200W Heating System
- (2) 4" Vents with Rain Shields and Screens
- (4) Pre-Wired 120VAC Outlets
- Removable 120VAC Terminal Block
- Aluminum Equipment Mounting Plate
- Stainless Steel Hinge and Quick Release Latches with Padlock Hasps
- Fiberglass Reinforced Polyester, FRP
- Weatherproof, UV Stable and Highly Corrosion Resistant
- NEMA Type 3R, 3RX / IP24 Rated
- Includes Cable Glands and Stainless Steel Mounting Feet
- RF Transparent Enclosure
- Pole Mounting Kit Available

Description

The **Altelix NF141206VFHA1** Heated/Fan Cooled Vented NEMA Enclosure is ideal for outdoor environments where temperatures vary between hot and cold. It is equipped with thermostat controlled heating and cooling systems to help keep your equipment within its operational temperature range. The aluminum equipment mounting plate features four pre-wired 120VAC power outlets for your equipment and a quick-connect top entry terminal block for easy wiring by a qualified installer. It is easily removable which helps simplify on-site wiring.

Thermostat Controlled Cooling Fan and 200W Heating System - Ideal for outdoor environments where temperatures vary between hot and cold, this enclosure features two 4" vents with rain shrouds and a thermostat-controlled cooling fan which helps maintain lower internal temperatures. Controlled by a separate thermostat, the 200W heating system is ideal for harsh weather and cold environments. Both the fan and heater are wired internally, leaving all the power outlets available for installed equipment.

Extreme Protection Built to Last - This rugged JIC style NEMA box is molded from durable UV stable and corrosion resistant fiberglass reinforced polyester (FRP) with a UL94-5V flame rating. The FRP material is dent-proof, non-conductive and RF transparent for compatibility with wireless equipment. It can be easily drilled and modified by the installer as needed. It features a gasketed door with stainless steel continuous hinge and stainless-steel quick release latches with padlock hasps. The generous size of this enclosure accommodates a wide range of equipment.

Specifications

Material	Fiberglass Reinforced Polyester
Color	Gray
Voltage / Max Load	120VAC / 15A @ 120VAC
Cooling Fan Turn-On Temperature	100°F (38°C)
Cooling Fan Turn-Off Temperature	79°F (26°C)
Heater Turn-On Temperature	43°F (6°C)
Heater Turn-Off Temperature	59°F (15°C)
Heater Power	200 Watts
Outer Dimensions	15.7 x 13.8 x 8.0 Inches (401 x 352 x 205 mm)
Inner Dimensions*	13.0 x 11.0 x 2.7 Inches (330 x 279 x 69 mm)
Mounting Plate Material	0.10 in (2.5 mm) Aluminum
Mounting Plate Dimensions	10.9 x 12.8 in. (276 x 324 mm)
Weight	13.0 lbs. (5.9 kg)
Terminal Block Wire Range	12-18 AWG
Terminal Block Strip Length	6-7mm
Ratings	NEMA Type 3R, 3RX / IP24
Flame Rating	UL94-5V

*See drawing for detailed dimensions of maximum space available for equipment.